

# ASK SIMON

THE DENTAL EXPERT



## SUCTION VALVE MAINTENANCE

- 1** Turn off the vacuum before disconnecting the valve.
- 2** Remove the tip (plastic or disposable) from the valve.
- 3** Remove the valve body by pulling it away from the tubing.
- 4** Remove the control valve (on/off swivel lever) by pushing it out of valve body.
- 5** Clean and rinse the valve body and control valve using a mild detergent, water, and the brushes that have been provided.
- 6** Allow the instruments to dry completely.
- 7** Autoclave.
- 8** Apply a light coat of A-dec silicone lubricant on the O-ring seals of the control valve.
- 9** Reinstall the control valve in the valve body, then reinstall the valve body on the tubing tailpiece.
- 10** Operate the valves several times to verify that they rotate smoothly.

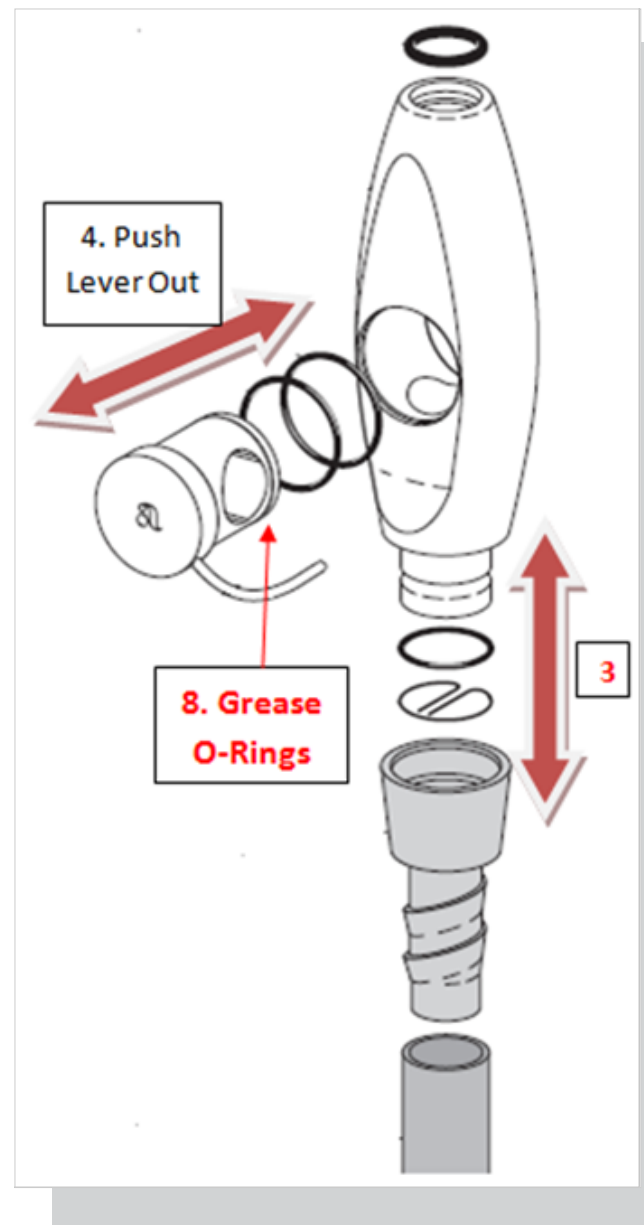

Contact Dental Medical Ireland today  
Tel: 1890 400 405

