

# Intego Treatment center care and cleaning plan

A continuously updated list of approved care, cleaning, and disinfecting agents can be downloaded from the Dentsply Sirona internet website under REF 5970905: <http://manuals.dentsplysirona.com>

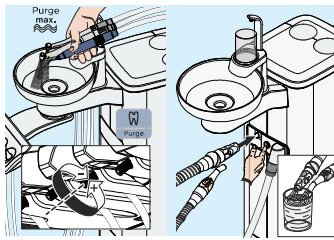

## In the morning

Clean/disinfect the water paths and suction system

Flush the tumbler filling  
Purge the 3-way syringe or the Sprayvit, and the instrument water paths with the purge function or manually.

Cleaning the suction hoses  
NOTE: If no hose cleaning present, aspirate a glass of cold water.

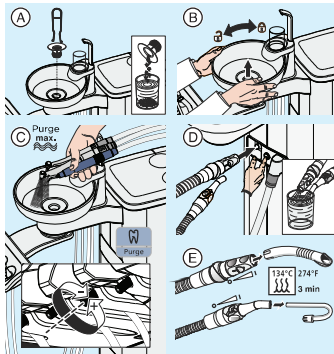

## After each patient

Clean/disinfect the water paths and suction system

CAUTION! Use only care, cleaning and disinfecting agents approved by Dentsply Sirona.

- A) Clean the gold trap
  - CAUTION! Dispose of amalgam residues in an environmentally-friendly manner!
  - B) Clean/disinfect the (removable) cuspidor bowl (special cleaning agent)
  - C) Purge the instruments that were used with the purge function or manually
  - D) Clean the suction hoses
  - NOTE: If no hose cleaning present, aspirate a glass of cold water.
  - E) Sterilize the suction cannula
- To prevent reflux, please use the suction cannula with supplementary air intakes.

## Clean/disinfect surfaces

CAUTION! Use only care, cleaning, and disinfecting agents approved by Dentsply Sirona!

- Disinfect surfaces and upholstery
- Disinfect user interfaces
- Care for, disinfect/sterilize treatment instruments (see operating instructions of the respective treatment instruments)
- Clean and disinfect/sterilize the components of the ApexLocator
- Disinfect instrument holders
- Disinfect handles
- Disinfect the tray
- Disinfect connectors for suction hose cleaning
- Maintain and clean the operating light (see LEDlight, LEDlight Plus or LEDview Plus operating instructions)

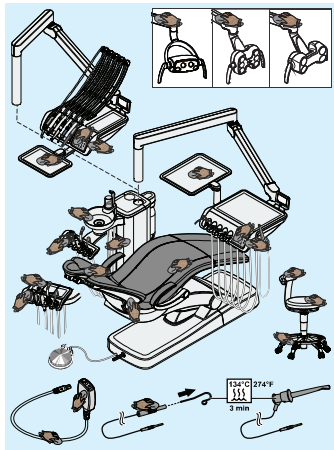

## In the evening

Clean/disinfect the water paths and suction system

Flush the tumbler filling  
Purge the 3-way syringe or the Sprayvit, and the instrument water paths with the purge function or manually.

Disinfect the suction hoses using the cleaning adapters (A)  
• daily at noon and  
• and at the end of the work day.

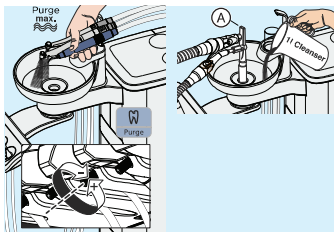

## Sterilize silicon mats / handle covers

Thermally disinfect the tray and cup holder  
Disinfect dentist and assistant element

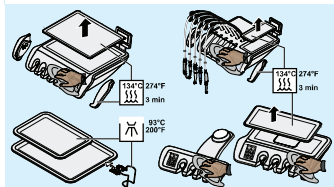

## Empty the central suction sieve

Wear protective gloves when emptying the central suction sieve!  
Collect amalgam residues in a closed container with water.

CAUTION! Dispose of amalgam residues in an environmentally correct manner.  
Clean emptied suction sieve under running water.

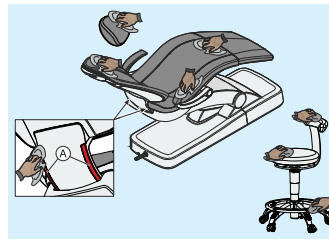
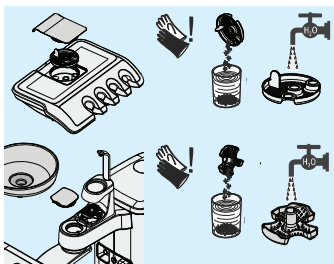

## Weekly

Clean and care for upholstery

CAUTION! Use only cleaning and care agents for upholstery approved by Dentsply Sirona!  
Follow the instructions for use of the cleaning and care agents exactly.  
Prevent agent FD360 from contacting chrome-plated surfaces.

Cleaning the bottom surface of the mount (A) for the backrest component

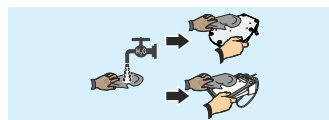

## Clean the foot control

Clean the bottom side of the foot control with a moist cloth (water).

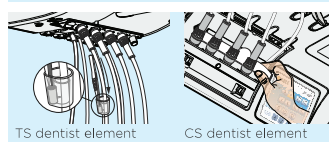

## TS dentist element

Change the cotton wool roll on the turbine hose

## CS dentist element

Change oil container

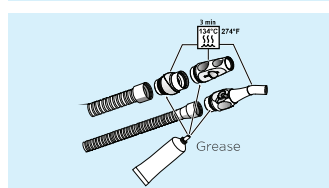

## Sterilize suction handpieces

Grease suction handpieces  
Separate suction handpieces and grease the O-rings after thermal disinfection or sterilization as well as once a week.

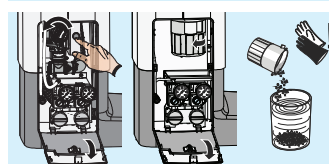

## Monthly or as required

Clean the filter insert of the standard wet suction

In the Start screen, press the "Extract residual water" button after removing the filter for cleaning.

Empty the collecting container of the air jet pump

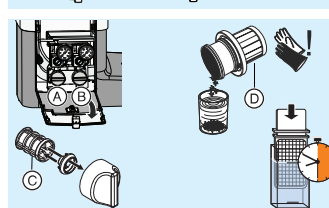

Change filter (C) for water (A) and air (B)  
NOTE Ensure that the treatment center is switched off before you replace the filters.

Empty the sediment tank (D) (optional)

Wear protective gloves when emptying the sediment tank!

## Microbiological water test

- At regular intervals according to results and
- after periods of disuse > 1 week.

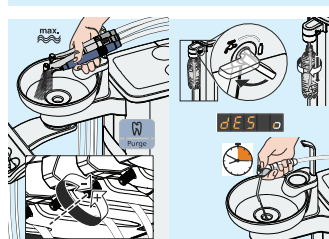

## Sanitize the treatment center

1. Set the maximum water flow on the instruments
2. Position the tumbler under the tumbler output
3. Switch to fresh water bottle
4. Fill the agent for disinfecting the water paths into fresh water bottle
5. Start sanitation
6. Treating the water paths with the agent for disinfecting the water lines
7. Allow 24 hours reaction time
8. Purge water lines with water
9. Cleaning the suction hoses

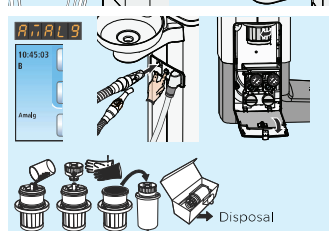

## Replace amalgam rotor

Caution! The rotor must be replaced after 12 months at the latest!

1. "Amalg" appears on the user interface. Conduct disinfection.
2. Only with the unit switched on: remove amalgam rotor.
3. Fill in collected amalgam residues, close amalgam rotor.
4. Remove amalgam rotor from lower part and dispose of in an environmentally correct manner.

For more details, refer to the operating instructions.  
The national requirements and recommendations for hygiene and disinfection must be observed (e.g. RKI, ADA, CDC etc).

# Intego Pro Treatment center care and cleaning plan

A continuously updated list of approved care, cleaning, and disinfecting agents can be downloaded from the Dentsply Sirona internet website under REF 5970905. <http://manuals.dentsplysirona.com>

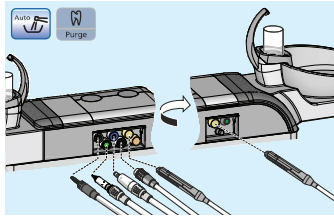

## In the morning

Automatically purge water paths (auto-purge function)

Insert the couplings into their corresponding adapters:

- White - Turbine
- Green - BL E motor
- Blue - BL ISO E motor (ISO interface)
- Red - SiroSonic L scaler
- Yellow - Sprayvit E, water on right button
- Orange - Sprayvit E, water on left button

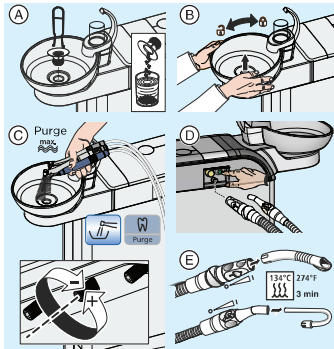

## After each patient

Clean/disinfect the water paths and suction system

CAUTION! Use only care, cleaning and disinfecting agents approved by Dentsply Sirona.

- Clean the gold trap
- Clean/disinfect the (removable) cuspidor bowl (special cleaning agent)
- Purge the water paths of used dentist element instruments (Purge function)
- Clean the suction hoses
- Sterilize the suction cannula  
To prevent reflux, please use the suction cannula with supplementary air intakes.

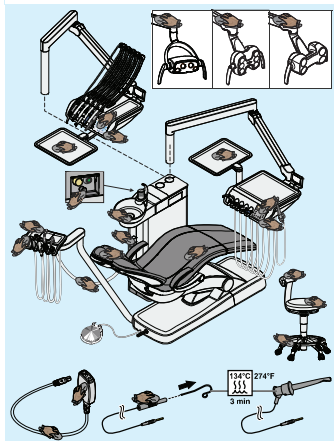

## Clean/disinfect surfaces

CAUTION! Use only care, cleaning, and disinfecting agents approved by Dentsply Sirona!

- Disinfect surfaces and upholstery
- Disinfect user interfaces
- Care for, disinfect/sterilize treatment instruments (see operating instructions of the respective treatment instruments)
- Clean and disinfect/sterilize the components of the ApexLocator
- Disinfect instrument holders
- Disinfect handles
- Disinfect the tray
- Disinfect connectors for suction hose cleaning
- Maintain and clean the operating light (see LEDlight, LEDlight Plus or LEDview Plus operating instructions)

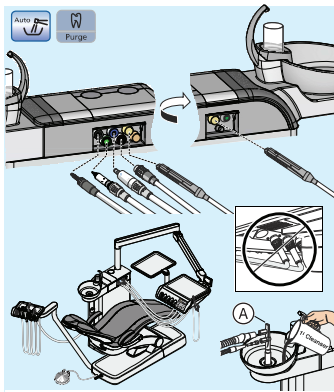

## In the evening

Automatically purge water paths (auto-purge function)

Insert the couplings into their corresponding adapters:

- White - turbine
- Green - BL E motor
- Blue - BL ISO E motor (ISO interface)
- Red - SiroSonic L scaler
- Yellow - Sprayvit E, water on right button
- Orange - Sprayvit E, water on left button

If the "Chemical hose cleaning" option is not available:

- Disinfect the suction hoses using the cleaning adapters (A)
- daily at noon and
- and at the end of the work day.

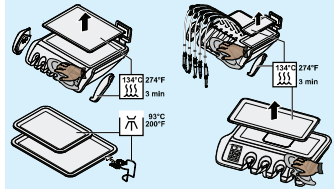

Sterilize silicon mats / handle covers  
Thermally disinfect the tray and cup holder  
Disinfect dentist and assistant element



## Empty the central suction sieve

Wear protective gloves when emptying the central suction sieve!

- Collect amalgam residues in a closed container with water.
- CAUTION! Dispose of amalgam residues in an environmentally correct manner.
- Clean emptied suction sieve under running water.

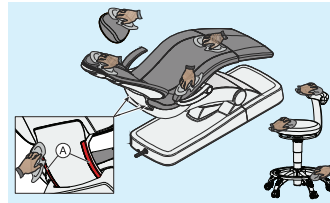

## Weekly

Clean and care for upholstery

CAUTION! Use only cleaning and care agents for upholstery approved by Dentsply Sirona! Follow the instructions for use of the cleaning and care agents exactly. Prevent agent FD360 from contacting chrome-plated surfaces.

Cleaning the bottom surface of the mount (A) for the backrest component

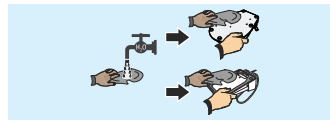

## Clean the foot control

Clean the bottom side of the foot control with a moist cloth (water).



If the "Chemical hose cleaning" option is not available:

Clean drainage lines  
The cleaning agents used for chemical cleaning of the hoses and of the suction system are identical (see REF 5970905).

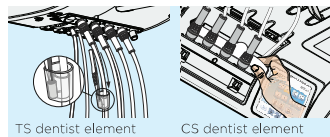

## TS dentist element

Change the cotton wool roll on the turbine hose

## CS dentist element

Change oil container

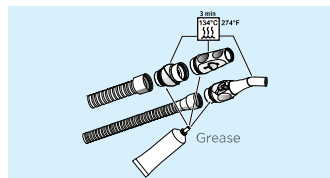

## Sterilize suction handpieces

## Grease suction handpieces

Separate suction handpieces and grease the O-rings after thermal disinfection or sterilization as well as once a week.

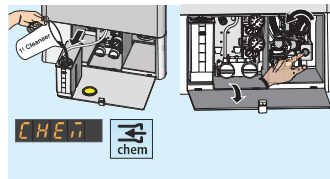

## Monthly or as required

### Refilling the cleaning agent tank

"chem" appears on the user interface: Refill the cleaning agent as soon as possible for chemical suction hose cleaning (optional).

Clean the filter insert of the standard wet suction

In the Start screen, press the "Extract residual water" button before removing the filter for cleaning.

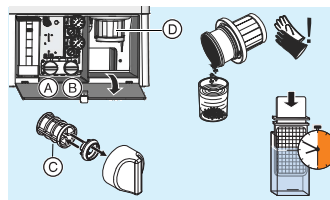

Change filter (C) for water (A) and air (B)  
NOTE Ensure that the treatment center is switched off before you replace the filters.

### Empty the sediment tank (D) (optional)

Wear protective gloves when emptying the sediment tank!

### Microbiological water test

- At regular intervals according to results and
- after periods of disuse > 1 week.

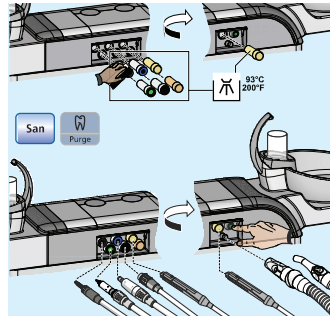

Clean and thermally disinfect the sanitation adapters manually inside and outside  
Sanitize the treatment center

For reduction of the biofilm within the fresh water carrying systems of the treatment center

- White - Turbine
  - Green - BL E motor
  - Blue - BL ISO E motor (ISO interface)
  - Red - SiroSonic L scaler
  - Yellow - Sprayvit E, water on right button
  - Orange - Sprayvit E, water on left button
- Cleaning the suction hoses after sanitation.

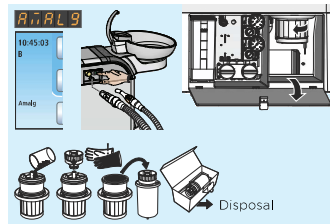

## Replace amalgam rotor

Caution! The rotor must be replaced after 12 months at the latest!

- "Amalg" appears on the user interface, Conduct disinfection.
- Only with the unit switched on: remove amalgam rotor.
- Fill in collected amalgam residues, close amalgam rotor.
- Remove amalgam rotor from lower part and dispose of in an environmentally correct manner.

For more details, refer to the operating instructions. The national requirements and recommendations for hygiene and disinfection must be observed (e.g. RKI, ADA, CDC etc).